

ART. A523

INDEXED CLAMPING LEVER WITH THREADED STUD

MATERIAL:

Special high resistance glass fibre reinforced technopolymer.
Oils and greases resistant.

SURFACE:

Satin.

LEVER BODY AND INSERT COLOUR:

Black (RAL 9011).

MAIN INSERT:

Zinc plated steel threaded stud.

FIXING SCREW:

Black-oxide treated screw with head for fitting screwdriver.

SPRING:

Zinc plated steel spring.



SPECIAL REQUESTS:

- It is possible to supply the inserts with different lengths, on request and for quantities.
- It is possible to supply the inserts in different materials, on request and for quantities.
- It is possible to supply the lever body with colours as shown in the table at page 22, on request and for quantities.

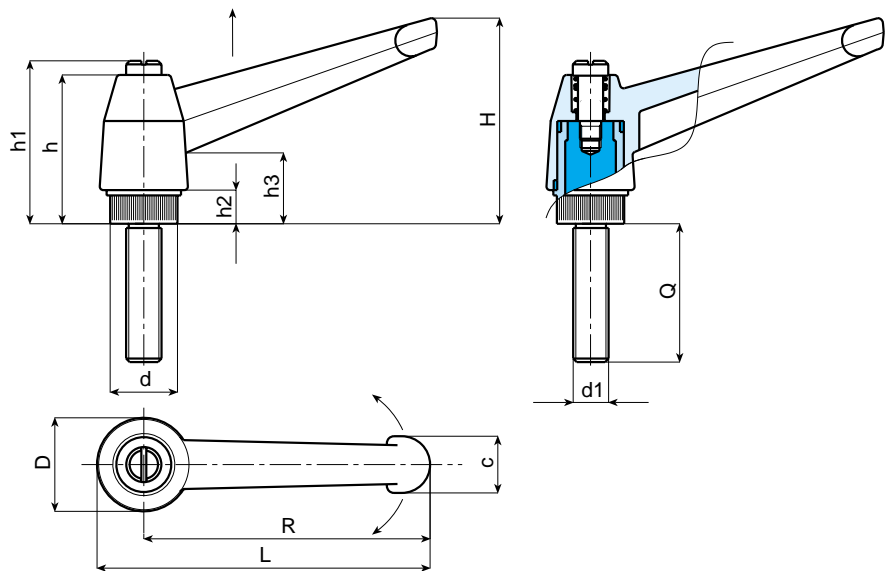

Art.	L	R	H	D	d	c	h	h1	h2	h3	d1	Q	Weight (gr)
A523-43 M04	52	43	33	17	11,5	11	27	30	6	14	M4	10-16-20-25-30-40	16-16-17-18-18-19
A523-43 M05	52	43	33	17	11,5	11	27	30	6	14	M5	10-16-20-25-30-40	16-17-17-17-18-19
A523-43 M06	52	43	33	17	11,5	11	27	30	6	14	M6	10-16-20-25-30-40	18-18-19-20-20-21
A523-65 M06	77	65	45	23	15	13	34	38	8	17	M6	16-20-25-30-40	33-34-35-37
A523-65 M08	77	65	45	23	15	13	34	38	8	17	M8	16-20-25-30-35-40-45-50	35-37-38-40-42-43-44-46
A523-83 M08	97	83	57	27	19	16	43	47	10	23	M8	20-25-30-35-40-50-60	58-59-61-62-64-67-70
A523-83 M10	97	83	57	27	19	16	43	47	10	23	M10	20-25-30-35-40-50-60	67-70-72-74-77-82-87
A523-83 M12	97	83	57	27	19	16	43	47	10	23	M12	20-25-30-35-40-50-60	79-82-86-89-93-100-107
A523-104 M10	121	104	70	33	24	19	50	53	11	26	M10	20-30-40-50-60	109-114-119-124-129
A523-104 M12	121	104	70	33	24	19	50	53	11	26	M12	20-30-40-50-60	115-122-129-136-143
A523-104 M14	121	104	70	33	24	19	50	53	11	26	M14	30-40-50-60-70	140-150-160-170-180
A523-104 M16	121	104	70	33	24	19	50	53	11	26	M16	30-40-50-60-70	156-170-184-198-212