

ART. A529

FIXED LEVER WITH THREADED STUD

MATERIAL:

Reinforced polyamide.
Oils and greases resistant.

SURFACE:

Satin.

COLOUR:

Black (RAL 9011).

MAIN INSERT:

Zinc plated steel threaded stud.

SPECIAL REQUESTS:

- It is possible to supply the inserts with different lengths, on request and for quantities.
- It is possible to supply the inserts in different materials, on request and for quantities.
- It is possible to supply colours as shown in the table at page 22, on request and for quantities.

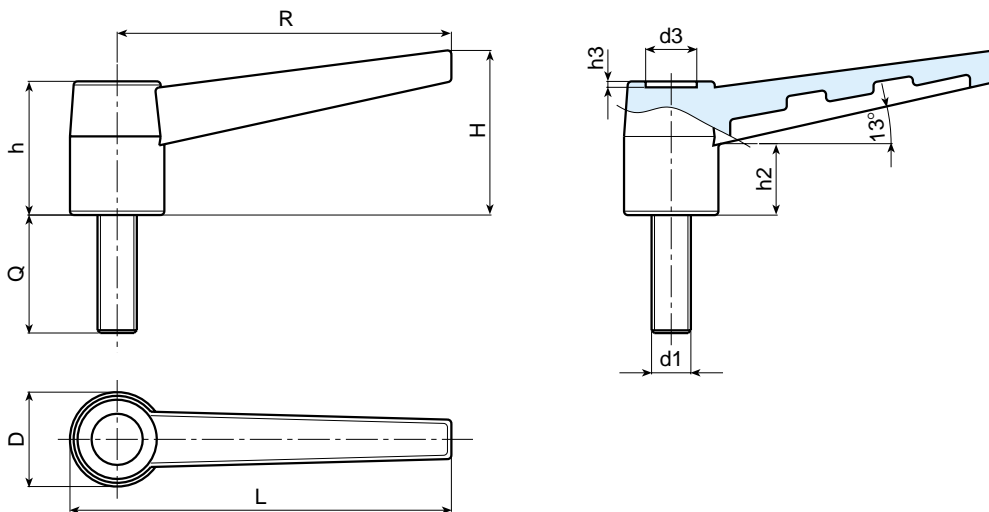

Art.	L	R	H	D	h	h2	h3	d3	d1	Q	Weight (gr)
A529-43 M05	50	43	21,5	15	19	9	1	7	M5	10-20-30	9-10-11
A529-43 M06	50	43	21,5	15	19	9	1	7	M6	10-20-30-40	10-12-14-16
A529-68 M06	78	68	36	21	28,5	11	2	10	M6	10-20-30-40	25-27-29-31
A529-68 M08	78	68	36	21	28,5	11	2	10	M8	16-20-30-40	30-32-36-39
A529-83 M06	93	83	40	24	34	18	2	13	M6	20-30	41-43
A529-83 M08	93	83	40	24	34	18	2	13	M8	20-30-40-50-60	44-47-50-53-56
A529-83 M10	93	83	40	24	34	18	2	13	M10	20-30-40	48-53-58

FIXED AND INDEXED LEVERS