

# ART. B320

## BRIDGE HANDLE WITH TUBE D.20

**PLASTIC END BRACKET MATERIAL:**

Reinforced polyamide.  
Oils and greases resistant.

**TUBE MATERIAL:**

Anodized aluminum UNI 4321.

**PLASTIC END BRACKET SURFACE:**

Satin.

**TUBE SURFACE:**

Satin.

**PLASTIC END BRACKET COLOUR:**

Black (RAL 9011).

**TUBE COLOUR:**

Silver.

**HOLE :**

Smooth right through hole obtained by moulding the plastic.

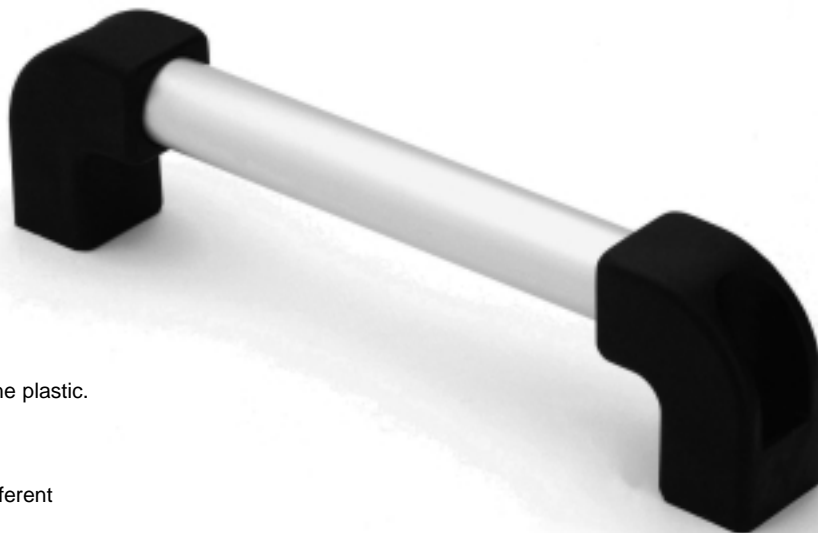

**SPECIAL REQUESTS:**

- It is possible to supply the bridge handle with different lengths, on request and for quantities.
- It is possible to supply the plastic end bracket with colours as shown in the table at page 22, on request and for quantities.
- It is possible to provide screw cover plugs on request.

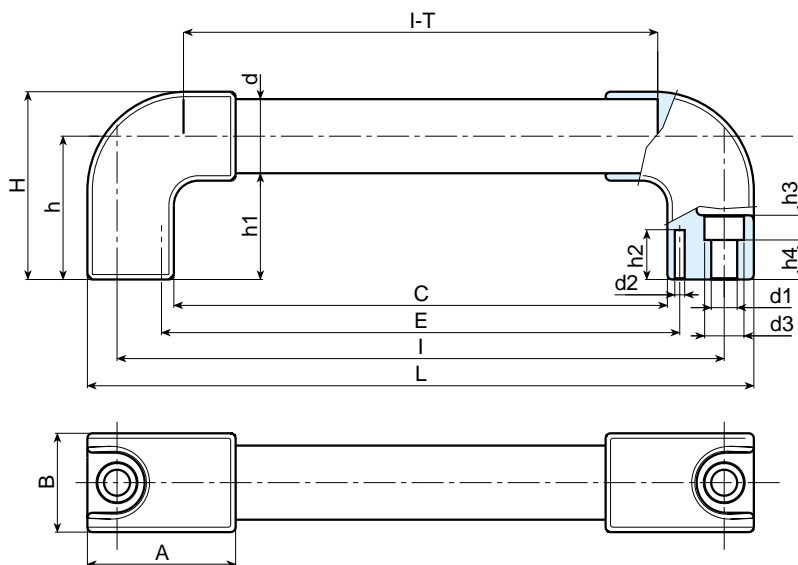

Art.	L	I	C	E	A	B	T	H	h	h1	h4	h3	h2	d	d1	d3	d2	Weight (gr)	F1 (N)	F2 (N)
B320-200	220	200	162	174	50	30	45	57	43	33	7	12,5	15	20	8,5	14,5	4	130	2400	1850
B320-250	270	250	212	224	50	30	45	57	43	33	7	12,5	15	20	8,5	14,5	4	145	1800	1450
B320-300	320	300	262	274	50	30	45	57	43	33	7	12,5	15	20	8,5	14,5	4	155	1500	1500
B320-350	370	350	312	324	50	30	45	57	43	33	7	12,5	15	20	8,5	14,5	4	165	1500	1250
B320-400	420	400	362	374	50	30	45	57	43	33	7	12,5	15	20	8,5	14,5	4	176	2400	850
B320-500	520	500	462	474	50	30	45	57	43	33	7	12,5	15	20	8,5	14,5	4	200	1000	800
B320-600	620	600	562	574	50	30	45	57	43	33	7	12,5	15	20	8,5	14,5	4	225	900	750
B320-700	720	700	662	674	50	30	45	57	43	33	7	12,5	15	20	8,5	14,5	4	250	600	600