

ART. D206

TWO SPOKE CONTROL HANDWHEEL WITH REVOLVING HANDLE

MATERIAL:

Reinforced and stabilised polyamide.
Oils and greases resistant.

SURFACE:

Satin.

HANDWHEEL AND HANDLE COLOUR:

Black (RAL 9011).

CENTRAL CAP:

Grey polyamide (RAL 7035 code 13).

ALTERNATIVE CAP COLOUR:

Orange (RAL 2004 code 02).
Blue (RAL 5015 code 07).
Yellow (RAL 1021 code 10).
Red (RAL 3000 code 16).
Green (RAL 6024 code 17).
Black (RAL 9011 code 01).

MAIN INSERT:

Zinc plated steel right through bored bush
with H7 tolerance.

SIDE INSERT:

Brass right through threaded bush.

(+) Black-oxide treated steel insert with hexagonal
threaded through hole. Fixed with black-oxide
treated hexagon socket button head screw
ISO 7838.

SIDE HANDLE:

Revolving handle Art. M144 (see chapter M on page 206).

HUB:

Solid hub. (*) Hollow underneath hub.

For fixing systems, or execution of tabs or square holes,
please refer to the technical notes attached to the catalogue.

SPECIAL REQUESTS:

- It is possible to supply the inserts with d1 diameter by customer design, on request and for quantities.
- It is possible to supply the inserts with threaded d1 diameter, on request and for quantities.
- It is possible to supply the inserts in different materials, on request and for quantities.
- It is possible to supply the inserts with different treatment-finishes, on request and for quantities.
- It is possible to supply the complete handwheels with colours as shown in the table at page 22, on request and for quantities.

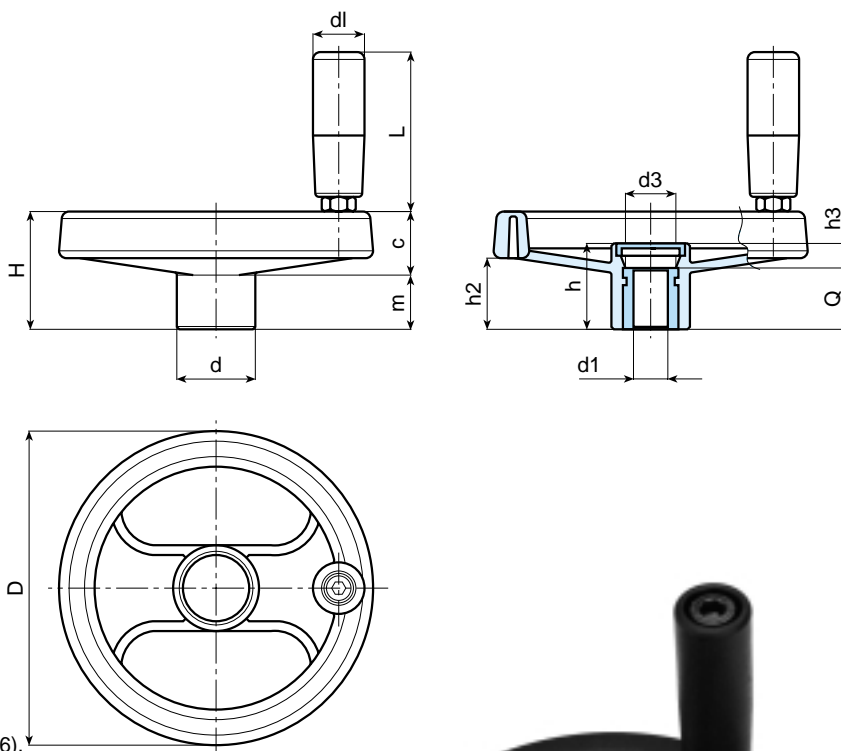

Art.	D	H	h	d	m	c	h2	h3	d3	d1 H7	Q	dm	dl	L	Weight (gr)
D206-80 D05	80	34	26	24,5	16	18	20	6	16	5 H9	20	12	20	56	125
D206-80 D10	80	34	26	24,5	16	18	20	6	16	10	20	12	20	56	124
D206-100 D05	99	43	33	28	20	23	26,5	9	16	5 H9	24	16	20	56	182
D206-100 D10	99	43	33	28	20	23	26,5	9	16	10	24	16	20	56	180
D206-130 D05	129	50	36	32	21	29	32	12	26	5 H9	24	18	21	65	296
D206-130 D12	129	50	36	32	21	29	32	12	26	12	24	18	21	65	293
D206-160 D05	159	57	40,5	40	22	35	34	8,5	26	5 H9	32	22	23	76	458
D206-160 D14	159	57	40,5	40	22	35	34	8,5	26	14	32	22	23	76	453
D206-200 D05	198	61,5	39,5	51	17,5	44	33	7,5	26	(*) 5 H9	32	22	23	76	700
D206-200 D16	198	61,5	39,5	51	17,5	44	33	7,5	26	(*) 16	32	22	23	76	692
D206-250 D05	252	70	47	55,5	24	46	39	11	24	(*) 5 H9	36	28	25	86	1030
D206-250 D20	252	70	47	55,5	24	46	39	11	24	(*) 20	36	28	25	86	1020
D206-350 D05	346	80	49,5	67,5	24	56	43,5	17,5	35	(*)(+) 5 H9	32	30	25	86	1640
D206-350 D20	346	80	49,5	67,5	24	56	43,5	17,5	35	(*)(+) 20	32	30	25	86	1630

It's possible to increase the hole, by boring, until dm.