

# ART. W464

## KNURLED METAL HANDWHEEL WITH THREADED STUD

**MATERIAL:**

Steel with property class 5.8.

**SURFACE:**

Low roughness turned surface.

**STANDARD COLOUR:**

H - Nickel-plated (surface treatment).

**ALTERNATIVO COLOUR ON REQUEST:**

Z - Galvanised (surface treatment).

D - Dacrome® (surface treatment).

To be specified with the order.

**STUD:**

Threaded stud in the steel with tolerance class of 6G.

**SPECIAL REQUESTS:**

- It is possible to supply the stud with different lengths, on request and for quantities.

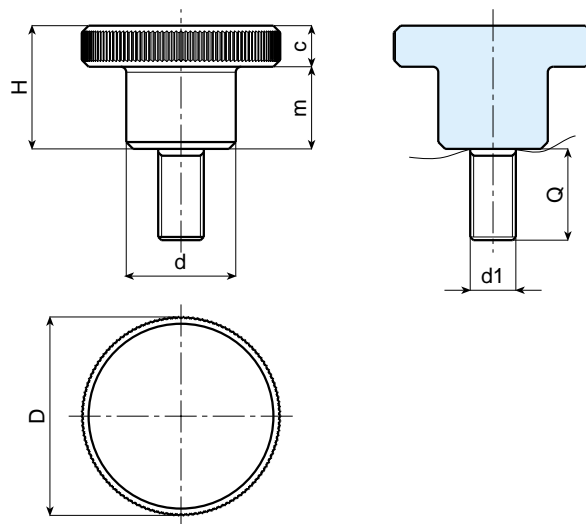

Art.	d	D	H	m	c	d1	Q	Weight (g)
W464-11 M3 "HZD"	6	11	8	5	3	M3	10-16	
W464-15 M4 "HZD"	8	15	10	6	4	M4	10-16-20-25	
W464-19 M5 "HZD"	10	19	12	8	4	M5	10-16-20-25-30	
W464-23 M6 "HZD"	12	23	15	10	5	M6	16-20-25-30-35	
W464-29 M8 "HZD"	16	29	18	12	6	M8	16-20-25-30-40	
W464-35 M10 "HZD"	20	35	23	15	8	M10	20-25-30-35-40	